

**Valve Regulated Lead Acid Battery**

Maintenance-Free Sealed Lead Acid Battery.

Absorbent Glass Mat (AGM) technology for efficient gas recombination of up to 99%.

**Design for Standby Power Applications**

**【Design Life】**

Up to 10 Years in Standby Service at 25°C

Eurobat (20°C) : 10-12 years, Long Life

**【Operating Temperature Range】**

Nominal Operating Temperature : 25°C (77°F)

Discharge : -15°C ~ 50°C (5°F~122°F)

Charge: -15°C ~ 40°C (5°F~104°F)

Storage: -15°C ~ 40°C (5°F~104°F)

**【Float Charging Voltage】**

13.5 ~ 13.8 VDC/Unit at 25°C (77°F)

**【Equalization Charging Voltage】**

14.4 ~ 15.0 VDC/Unit at 25°C (77°F)

**【Self Discharge】**

Less than 10% after 90 days, can be stored up to 6 months at 25°C (77°F);

Fully recharging is required before usage, and charged sooner if stored at higher temperature than 25°C (77°F).

**Specification**

Design according with IEC 60896-21/22:2004

Nominal Voltage	12V (6 cells per unit)		
Nominal Capacity	4700W @5min-rate to 1.60V per PCS @25°C (77°F)		
Weight	Approx. 32.40 Kg (71.41 lbs)		
Maximum Discharge Current	800A (5sec)		
Internal Resistance	Approx. 3.00 mΩ		
Short Circuit Current	--		
Maximum Charge Current	43A		
Terminal types	I2 thread lead alloy terminal to accept M6 bolt		
Terminal hardware Torque	138.6 Kgf-cm / 120.3 Lbf-in / 13.58 N-m		
Container Material	Flame Retardant Polypropylene (UL 94-V0)		
Dimensions	Length (L)	308.7±2.5 mm	12.15±0.10 inch
	Width (W)	169.0±2.0 mm	6.65±0.08 inch
	Container Height (h)	210.6±2.5 mm	8.29±0.10 inch
	Overall Height (H)	213.6±2.5 mm	8.41±0.10 inch

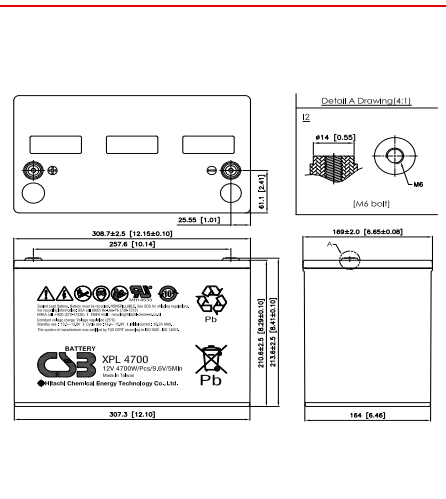

**Constant Current Discharge Characteristics Unit: A (25°C, 77°F)**

F.V/Time	2MIN	4MIN	5MIN	6MIN	8MIN	10MIN	15MIN	20MIN	30MIN	45MIN	60MIN	90MIN
1.60V												
1.67V												
1.70V												
1.75V												
1.80V												
1.85V												

**Constant Power Discharge Characteristics Unit: W (25°C, 77°F)**

F.V/Time	2MIN	4MIN	5MIN	6MIN	8MIN	10MIN	15MIN	20MIN	30MIN	45MIN	60MIN	90MIN
1.60V	5941	5032	4768	4519	3933	3487	2717	2189	1613	1154	910	651
1.67V	5489	4786	4549	4264	3717	3341	2633	2137	1593	1142	902	647
1.70V	5266	4673	4395	4097	3606	3254	2580	2104	1578	1134	897	645
1.75V	4839	4376	4065	3792	3398	3078	2465	2025	1535	1109	881	637
1.80V	4602	3920	3665	3469	3133	2836	2315	1913	1463	1066	851	620
1.85V	3873	3439	3281	3105	2787	2537	2090	1745	1353	995	800	588

\*\*Preliminary spec sheet

Issued: 180213

**Sales Offices**

**日立化成能源科技股份有限公司**  
Hitachi Chemical Energy Technology Co., Ltd.

Recognized under UL 1989,  
and certified by ISO 9001, 14001.



**BUSINESS HEADQUARTERS**

Tel: +886-2-2880-5600

Fax: +866-2-2888-3300

**USA OFFICE**

Tel: +1-817-244-7777 / 1-(800)3-CSB-USA (272872)

Fax: +1-817-244-4445

**SHENZHEN OFFICE (CHINA)**

Tel: +86-755-8831-6488, 8831-6775

Fax: +86-755-8831-6075

**EUROPE (EMEA) OFFICE**

Tel: +31(0)180-418-140

Fax: +31(0)180-418-327

**SHANGHAI OFFICE (CHINA)**

Tel: +86-21-5046-1622, 5046-0833

Fax: +86-21-5046-1046

**TAIPEI OFFICE**

Tel: +886-2-2880-5600

Fax: +866-2-2888-3300

**BEIJING OFFICE (CHINA)**

Tel: +86-10-5820-5336, 5820-5338

Fax: +86-10-5820-3053