

UPS ULTRA HIGH RATE

XP6-620FR (6V, 681.0WPC, 191.2AH)

Specification

Nominal Voltage	6V
Nominal Capacity(8 HR)	191.2 Ah at 1.75V/cell @ 25°C/77°F
Watts(15 min rate)	681.0 Watts/cell at 1.67V/cell @ 25°C/77°F
Dimensions	Length 322mm(12.7 inches)
	Width 178mm(7.0 inches)
	Container Height 228mm(9.0 inches)
	Total Height (with Terminal) 231mm(9.1 inches)
Approx Weight	Approx 29.0 kg (64.0 lbs)
Terminal	T8 with a copper alloy insert for a M6 bolt
Container Material	Flame Retardant ABS to UL94-V0
Rated Capacity	210.0 AH/10.5A (20hr, 1.80V/cell, 25°C/77°F)
	191.2 AH/23.9A (8hr, 1.75V/cell, 25°C/77°F)
	178.5 AH/35.7A (5hr, 1.75V/cell, 25°C/77°F)
	163.8 AH/54.6A (3hr, 1.75V/cell, 25°C/77°F)
	141.8 AH/141.8A (1hr, 1.60V/cell, 25°C/77°F)
Max. Discharge Current	2520A (5s)
Internal Resistance	Approx 63.0mΩ
Operating Temp.Range	Discharge : -20~55°C (-4~131°F)
	Charge : 0~50°C (32~122°F)
	Storage : -20~55°C (-4~131°F)
Nominal Operating Temperature	20 to 25°C (68 to 77°F)
Standby Use (Float Voltage)	No limit on Initial Charging Current
	Voltage 6.75~6.9V at 25°C(77°F) Temp. Coefficient -10mV/°C
Cycle Use	Initial Charging Current less than 63.0A
	Voltage 7.2V~7.5V at 25°C(77°F) Temp. Coefficient -15mV/°C
Capacity affected by Temperature	40°C (104°F) 103%
	25°C (77°F) 100%
	0°C (32°F) 86%
Self Discharge	≤3% of capacity declined per month at 25°C



Application

- ◆ Critical UPS (High rate) applications
- ◆ High power backup supply
- ◆ Emergency power supply
- ◆ Emergency lighting
- ◆ Electric starting

Compliant Standards

- Eurobat Classification:*
- ◆ High Performance (10~12 years design life)
 - ◆ IEC60896-21/22:2004
 - ◆ BS 6290 Part 4

Constant Current Discharge (Amperes) at 25 °C (77°F)

F.V/Time	5min	10min	15min	20min	30min	45min	1h	2h	3h	4h	5h	6h	8h	10h	20h
1.85V/cell	378.0	313.7	274.7	239.4	183.9	139.4	115.3	68.7	50.7	40.9	34.1	29.1	22.9	19.1	10.2
1.80V/cell	441.0	352.8	298.2	256.8	197.4	149.1	121.0	71.7	52.9	42.3	34.9	29.9	23.5	19.5	10.5
1.75V/cell	516.6	383.0	321.7	272.0	209.0	156.2	126.4	74.3	54.6	43.4	35.7	30.5	23.9	19.9	10.7
1.70V/cell	544.3	409.5	343.6	289.8	221.5	164.9	132.7	76.8	56.0	44.3	36.4	31.1	24.3	20.2	10.9
1.67V/cell	584.4	438.4	364.6	304.2	231.0	170.8	137.1	78.9	57.0	44.9	37.0	31.6	24.7	20.6	11.1
1.60V/cell	633.7	468.7	384.7	318.8	240.5	177.0	141.8	81.3	58.5	45.9	37.8	32.3	25.3	21.0	11.3

Constant Power Discharge (Watts/Cell) at 25 °C (77°F)

F.V/Time	5min	10min	15min	20min	30min	45min	1h	2h	3h	4h	5h	6h	8h	10h	20h
1.85V/cell	719.0	603.6	532.1	466.4	360.5	275.0	228.7	137.0	101.4	82.3	68.8	59.1	46.8	39.3	21.0
1.80V/cell	829.1	673.1	572.5	496.5	383.9	291.7	238.2	141.9	105.2	84.6	70.0	60.1	47.5	39.9	21.6
1.75V/cell	962.1	721.4	612.2	522.0	403.5	303.4	247.0	146.1	107.9	86.1	71.1	61.1	48.1	40.4	22.0
1.70V/cell	1003.7	764.1	647.4	552.0	424.4	317.8	257.5	149.9	109.9	87.5	72.2	62.0	48.7	40.9	22.2
1.67V/cell	1066.5	809.2	681.0	574.8	440.1	327.4	264.7	153.1	111.3	88.4	73.1	62.8	49.2	41.3	22.5
1.60V/cell	1134.4	847.4	706.0	589.9	448.6	332.9	268.6	155.1	112.1	88.6	73.3	63.0	49.7	41.4	22.5



Dimensions

T8 Terminal

Unit: mm [inches]

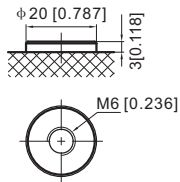

Unit: mm [inches]

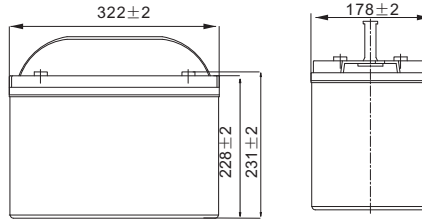
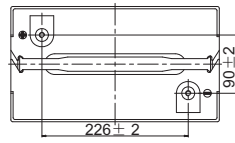

Discharge Characteristics

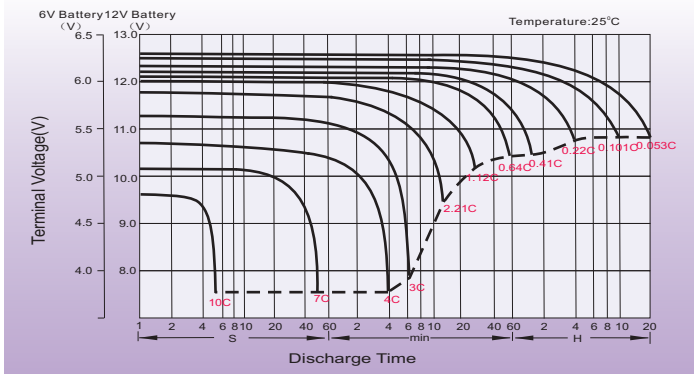

Float Charging Characteristics

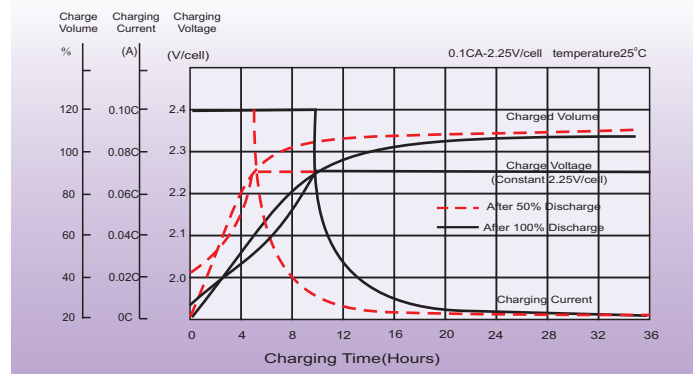

Temperature Effects in Relation to Battery Capacity

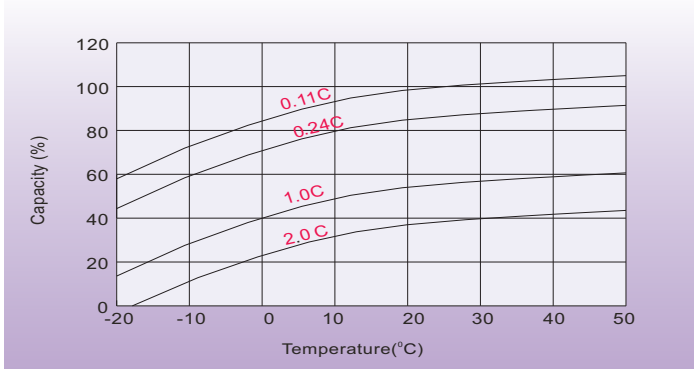

Effect of Temperature on Long Term Float Life

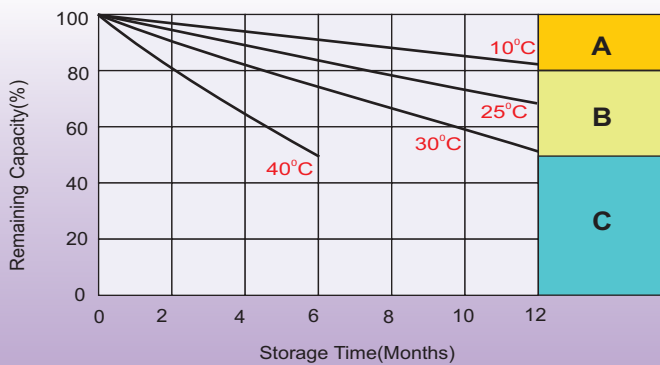
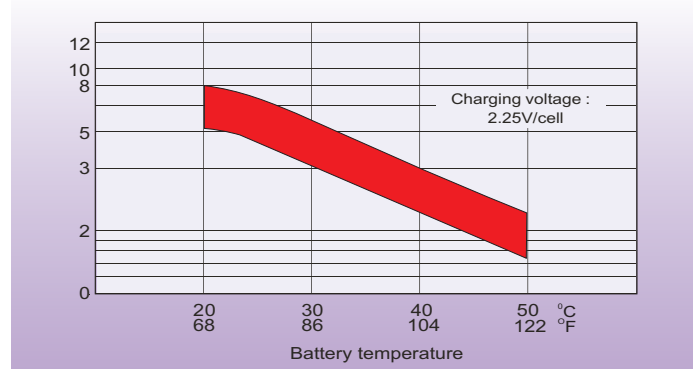

Self Discharge Characteristics

- A** No supplementary charge required
(Carry out supplementary charge before use if 100% capacity is required.)
- B** Supplementary charge required before use. Optional charging way as below:
 1. Charged for above 3 days at limited current 0.25CA and constant volatge 2.25V/cell.
 2. Charged for above 20hours at limited current 0.25CA and constant volatge 2.45V/cell.
 3. Charged for 8-10hours at limited current 0.05CA .
- C** Supplementary charge may often fail to recover the capacity.
The battery should never be left standing till this is reached.

Sales Office

North America sales office:
19751 Descartes, Unit A ,
Foothill Ranch, CA 92610, USA
Tel: 949-588-5853
Fax: 949-588-5966
E-mail: sales@leoch.us
Http://www.leoch.us

Atlanta Office:
1395 S. arietta Parkway Building 400
Suite 108 arietta, GA 30067
Tel: 678-403-1083
E-mail: sales@leoch.us

China sales office:
5th Floor, Xinbaohui Bldg.,Nanhai Blvd.,
Nanshan,Shenzhen, China. 518052
Tel: +86-755-86036060 (100 lines)
Fax: +86-755-26067269
E-mail: export@leoch.com

Europe sales office:
9 B Wheatstone Court. Waterwells
usineBs Park, Gloucester, GL2-2AQ,
K United Kingdom
Tel: +44(0) 1452 729428 / 1452 729696
Fax: +44 (0)1452-690125
E-mail: Sales.Europe@leoch.com