

Specification

Nominal Voltage	12V
Nominal Capacity(8 HR)	51.6 Ah at 1.75V/cell @ 25°C/77°F
Watts(15 min rate)	225.1 Watts/cell at 1.67V/cell @ 25°C/77°F
Dimensions	Length 229mm(9.02inches)
	Width 138mm(5.43inches)
	Container Height 200mm(7.87inches)
	Total Height (with Terminal) 203mm(7.99inches)
Approx Weight	Approx 17.3 kg (38.1lbs)
Terminal	T6 with copper alloy insert for a M6 bolt
Container Material	Flame Retardant ABS to UL94-V0
Rated Capacity	55.0 AH/2.75A (20hr, 1.80V/cell, 25°C/77°F)
	51.6 AH/6.45A (8hr, 1.75V/cell, 25°C/77°F)
	47.4 AH/9.47A (5hr, 1.75V/cell, 25°C/77°F)
	43.8 AH/14.6A (3hr, 1.75V/cell, 25°C/77°F)
	38.9 AH/38.9A (1hr, 1.60V/cell, 25°C/77°F)
Max. Discharge Current	825A (5s)
Internal Resistance	Approx 5.0mΩ
Operating Temp. Range	Discharge : -20~55°C (-4~131°F)
	Charge : 0~50°C (32~122°F)
	Storage : -20~55°C (-4~131°F)
Nominal Operating Temperature	20 to 25°C (68 to 77°F)
Standby Use (Float Voltage)	No limit on Initial Charging Current. 13.5V~13.8V at 25°C (77°F) Temp. Coefficient -20mV/°C
Cycle Use	Initial Charging Current less than 16.5A. 14.4V~15.0V at 25°C (77°F) Temp. Coefficient -30mV/°C
Capacity affected by Temperature	40°C (104°F) 103%
	25°C (77°F) 100%
	0°C (32°F) 86%
Self Discharge	≤3% of capacity declined per month at 25°C



Application

- ◆ Critical UPS (High rate) applications
- ◆ High power backup supply
- ◆ Emergency power supply
- ◆ Emergency lighting
- ◆ Electric starting

Compliant Standards

- Eurobat Classification:*
- ◆ High Performance (10~12 years design life)
 - ◆ IEC60896-21/22:2004
 - ◆ BS 6290 Part 4

Constant Current Discharge (Amperes) at 25 °C (77°F)

F.V/Time	5min	10min	15min	20min	30min	45min	1h	2h	3h	4h	5h	6h	8h	10h	20h
1.85V/cell	134.8	100.4	84.5	72.8	55.8	40.6	32.5	19.2	13.7	10.8	8.99	7.75	6.16	5.13	2.64
1.80V/cell	160.4	114.2	95.7	80.2	60.0	43.0	34.2	20.0	14.2	11.2	9.28	7.97	6.33	5.26	2.75
1.75V/cell	185.3	126.4	103.4	85.8	62.8	45.0	35.4	20.6	14.6	11.4	9.47	8.13	6.45	5.36	2.81
1.70V/cell	200.9	137.7	110.9	91.2	66.0	46.6	36.6	21.0	15.0	11.7	9.69	8.32	6.59	5.45	2.86
1.67V/cell	217.6	145.5	118.7	96.0	68.3	48.2	37.8	21.6	15.2	11.9	9.88	8.49	6.71	5.56	2.91
1.60V/cell	234.2	155.6	123.8	100.0	70.8	49.9	38.9	22.0	15.5	12.2	10.1	8.73	6.88	5.68	2.99

Constant Power Discharge (Watts/Cell) at 25 °C (77°F)

F.V/Time	5min	10min	15min	20min	30min	45min	1h	2h	3h	4h	5h	6h	8h	10h	20h
1.85V/cell	262.3	196.5	166.3	143.9	110.9	81.1	65.0	38.5	27.7	21.9	18.3	15.8	12.6	10.5	5.46
1.80V/cell	308.7	221.1	186.4	157.0	118.1	85.3	68.0	39.9	28.6	22.5	18.8	16.2	12.9	10.8	5.65
1.75V/cell	353.2	242.4	199.6	166.5	122.7	88.3	70.0	41.0	29.2	22.9	19.0	16.4	13.1	10.9	5.75
1.70V/cell	378.4	261.2	211.5	175.2	127.6	90.6	71.8	41.4	29.7	23.3	19.3	16.7	13.3	11.0	5.81
1.67V/cell	406.6	274.0	225.1	183.2	131.4	93.3	73.7	42.3	30.0	23.6	19.6	16.9	13.4	11.2	5.89
1.60V/cell	432.7	289.8	232.3	189.0	134.8	95.6	75.2	42.7	30.4	24.0	20.0	17.2	13.6	11.3	5.98



Dimensions

T6 Terminal

Unit: mm [inches]

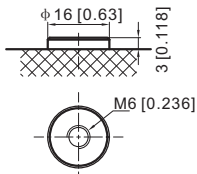

Unit: mm [inches]

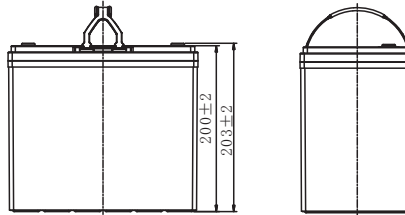
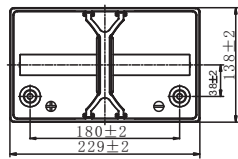

Discharge Characteristics

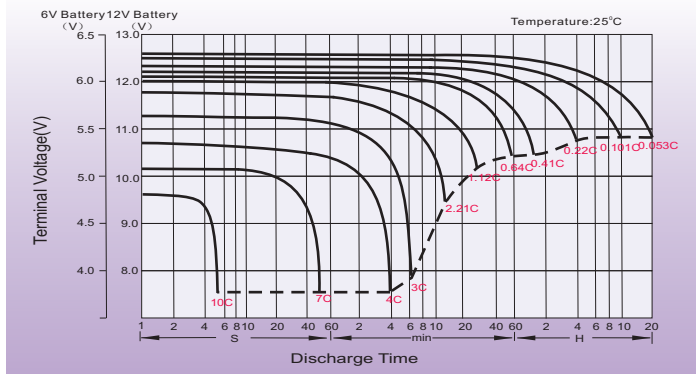

Float Charging Characteristics

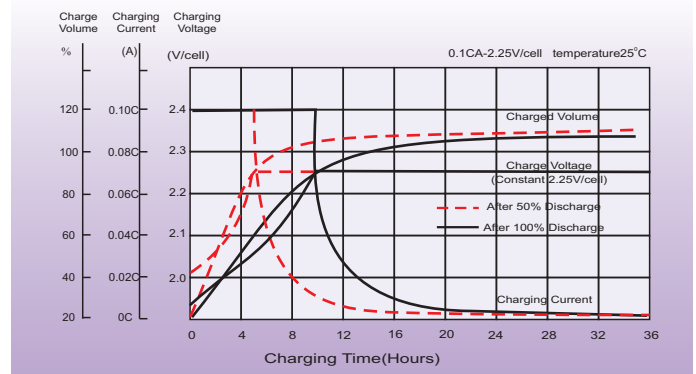

Temperature Effects in Relation to Battery Capacity

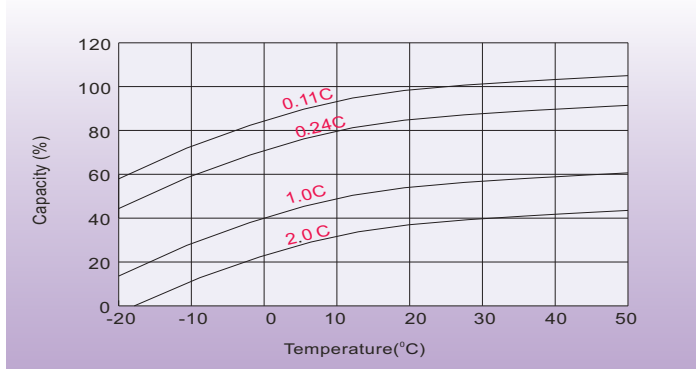

Effect of Temperature on Long Term Float Life

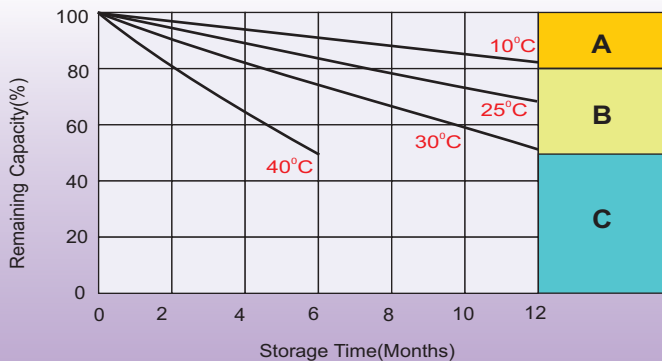
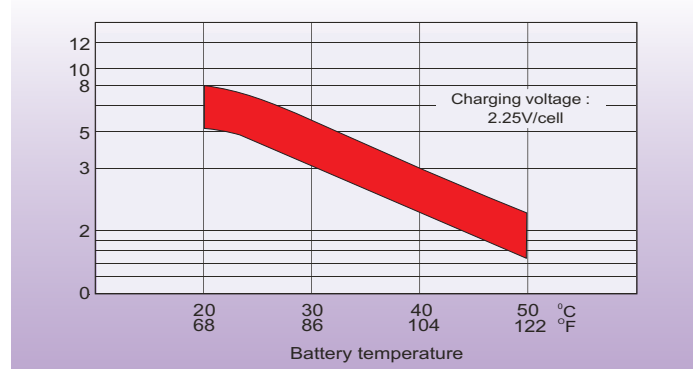

Self Discharge Characteristics

- A** No supplementary charge required
(Carry out supplementary charge before use if 100% capacity is required.)
- B** Supplementary charge required before use. Optional charging way as below:
 1. Charged for above 3 days at limited current 0.25CA and constant volatge 2.25V/cell.
 2. Charged for above 20hours at limited current 0.25CA and constant volatge 2.45V/cell.
 3. Charged for 8-10hours at limited current 0.05CA .
- C** Supplementary charge may often fail to recover the capacity.
The battery should never be left standing till this is reached.

Sales Office

North America sales office:
19751 Descartes, Unit A ,
Foothill Ranch, CA 92610, USA
Tel: 949-588-5853
Fax: 949-588-5966
E-mail: sales@leoch.us
Http://www.leoch.us

Atlanta Office:
1395 S. arietta Parkway Building 400
Suite 108 arietta, GA 30067
Tel: 678-403-1083
E-mail: sales@leoch.us

China sales office:
5th Floor, Xinbaohui Bldg.,Nanhai Blvd.,
Nanshan,Shenzhen, China. 518052
Tel: +86-755-86036060 (100 lines)
Fax: +86-755-26067269
E-mail: export@leoch.com

Europe sales office:
9 B Wheatstone Court. Waterwells
useineBs Park, Gloucester, GL2-2AQ,
K United Kingdom
Tel: +44(0) 1452 729428 / 1452 729696
Fax: +44 (0)1452-690125
E-mail: Sales.Europe@leoch.com