

Specification

Nominal Voltage	12V
Nominal Capacity(8 HR)	25.8 Ah at 1.75V/cell @ 25°C/77°F
Watts(15 min rate)	92.8 Watts/cell at 1.67V/cell @ 25°C/77°F
Dimensions	Length 164mm(6.46inches)
	Width 125mm(4.92inches)
	Container Height 172mm(6.77inches)
	Total Height (with Terminal) 175mm(6.89inches)
Approx Weight	Approx 7.90 kg (17.4 lbs)
Terminal	T12 with copper alloy insert for a M5 bolt
Container Material	Flame Retardant ABS to UL94-V0
Rated Capacity	27.0 AH/1.35A (20hr, 1.80V/cell, 25°C/77°F)
	25.8 AH/3.22A (8hr, 1.75V/cell, 25°C/77°F)
	23.8 AH/4.75A (5hr, 1.75V/cell, 25°C/77°F)
	22.0 AH/7.32A (3hr, 1.75V/cell, 25°C/77°F)
	18.6 AH/18.6A (1hr, 1.60V/cell, 25°C/77°F)
Max. Discharge Current	540A (5s)
Internal Resistance	Approx 12.0mΩ
Operating Temp.Range	Discharge : -20~55°C (-4~131°F)
	Charge : 0~50°C (32~122°F)
	Storage : -20~55°C (-4~131°F)
Nominal Operating Temperature	20 to 25°C (68 to 77°F)
Standby Use (Float Voltage)	No limit on Initial Charging Current. 13.5V~13.8V at 25°C (77°F) Temp. Coefficient -20mV/°C
Cycle Use	Initial Charging Current less than 8.1A.
	14.4V~15.0V at 25°C (77°F) Temp. Coefficient -30mV/°C
Capacity affected by Temperature	40°C (104°F) 103%
	25°C (77°F) 100%
	0°C (32°F) 86%
Self Discharge	≤3% of capacity declined per month at 25°C



Application

- ◆ Critical UPS (High rate) applications
- ◆ High power backup supply
- ◆ Emergency power supply
- ◆ Emergency lighting
- ◆ Electric starting

Compliant Standards

- Eurobat Classification:*
- ◆ High Performance (10~12 years design life)
 - ◆ IEC60896-21/22:2004
 - ◆ BS 6290 Part 4

Constant Current Discharge (Amperes) at 25 °C (77°F)

F.V/Time	5min	10min	15min	20min	30min	45min	1h	2h	3h	4h	5h	6h	8h	10h	20h
1.85V/cell	62.5	47.7	39.0	33.0	25.7	19.5	15.8	9.40	6.86	5.44	4.51	3.88	3.05	2.54	1.32
1.80V/cell	71.2	52.8	42.2	34.9	27.2	20.6	16.8	9.88	7.12	5.61	4.67	4.01	3.15	2.61	1.35
1.75V/cell	81.1	56.4	44.8	37.3	28.3	21.3	17.3	10.2	7.32	5.74	4.75	4.08	3.22	2.66	1.38
1.70V/cell	89.1	60.3	46.8	38.6	29.2	21.9	17.7	10.4	7.47	5.88	4.87	4.19	3.29	2.71	1.40
1.67V/cell	94.8	63.0	48.9	40.1	30.1	22.5	18.2	10.6	7.62	5.98	4.98	4.28	3.34	2.75	1.43
1.60V/cell	98.5	65.1	50.5	41.5	31.1	23.0	18.6	10.8	7.76	6.12	5.10	4.37	3.41	2.81	1.47

Constant Power Discharge (Watts/Cell) at 25 °C (77°F)

F.V/Time	5min	10min	15min	20min	30min	45min	1h	2h	3h	4h	5h	6h	8h	10h	20h
1.85V/cell	121.5	93.3	76.8	65.3	51.0	38.9	31.7	18.9	13.9	11.0	9.18	7.91	6.26	5.22	2.74
1.80V/cell	137.1	102.2	82.2	68.4	53.6	40.8	33.4	19.8	14.3	11.3	9.45	8.13	6.42	5.33	2.77
1.75V/cell	154.5	108.1	86.6	72.3	55.3	41.7	34.1	20.2	14.6	11.5	9.55	8.23	6.52	5.42	2.82
1.70V/cell	167.8	114.3	89.2	74.2	56.6	42.6	34.8	20.5	14.8	11.7	9.72	8.39	6.61	5.47	2.85
1.67V/cell	177.1	118.7	92.8	76.3	57.9	43.4	35.5	20.8	15.0	11.8	9.89	8.53	6.70	5.54	2.89
1.60V/cell	181.9	121.3	94.8	78.2	59.3	44.0	35.9	21.0	15.2	12.0	10.0	8.62	6.77	5.61	2.94



Dimensions

T12 Terminal

Unit: mm [inches]

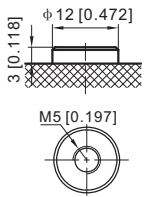

Unit: mm [inches]

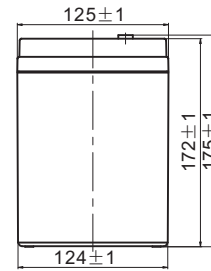
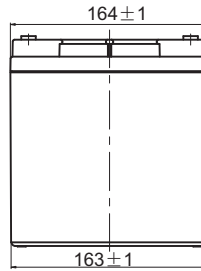
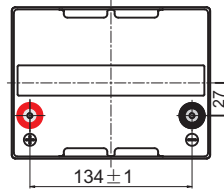

Discharge Characteristics

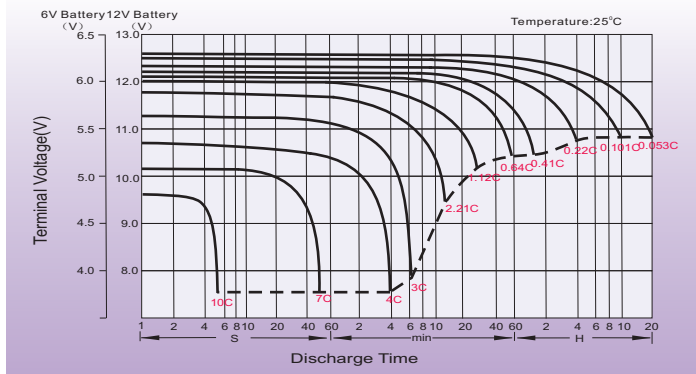

Float Charging Characteristics

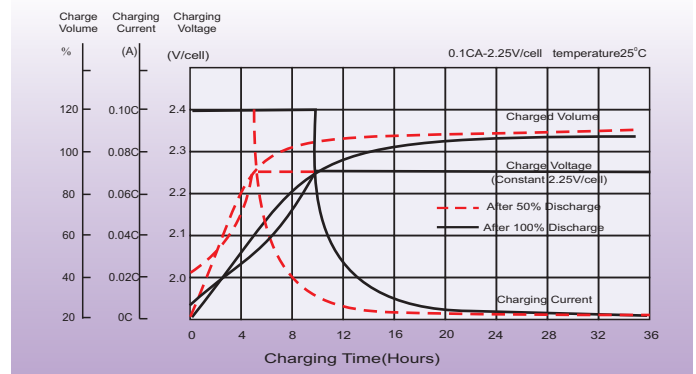

Temperature Effects in Relation to Battery Capacity

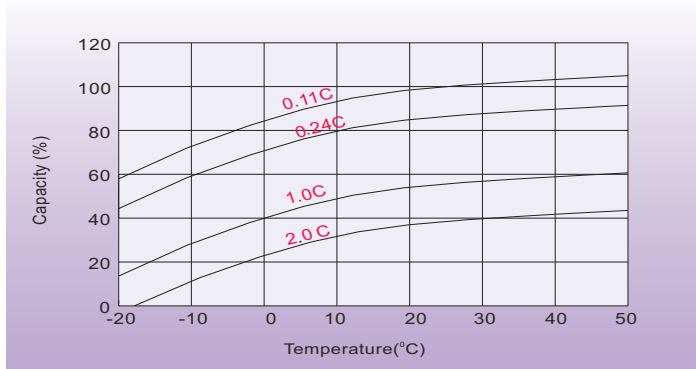

Effect of Temperature on Long Term Float Life

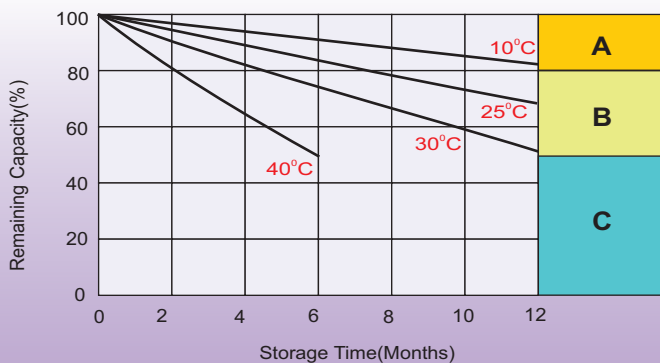
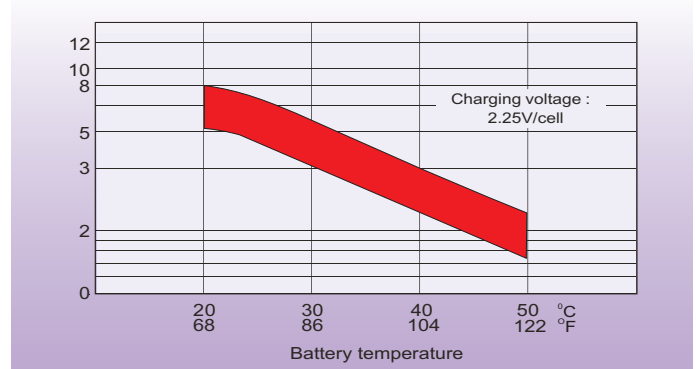

Self Discharge Characteristics

- A** No supplementary charge required
(Carry out supplementary charge before use if 100% capacity is required.)
- B** Supplementary charge required before use. Optional charging way as below:
 1. Charged for above 3 days at limited current 0.25CA and constant volatge 2.25V/cell.
 2. Charged for above 20hours at limited current 0.25CA and constant volatge 2.45V/cell.
 3. Charged for 8-10hours at limited current 0.05CA .
- C** Supplementary charge may often fail to recover the capacity.
The battery should never be left standing till this is reached.

Sales Office

North America sales office:
19751 Descartes, Unit A ,
Foothill Ranch, CA 92610, USA
Tel: 949-588-5853
Fax: 949-588-5966
E-mail: sales@leoch.us
Http://www.leoch.us

Atlanta Office:
1395 S. arietta Parkway Building 400
Suite 108 arietta, GA 30067
Tel: 678-403-1083
E-mail: sales@leoch.us

China sales office:
5th Floor, Xinbaohui Bldg.,Nanhai Blvd.,
Nanshan,Shenzhen, China. 518052
Tel: +86-755-86036060 (100 lines)
Fax: +86-755-26067269
E-mail: export@leoch.com

Europe sales office:
9 B Wheatstone Court. Waterwells
usineBs Park, Gloucester, GL2-2AQ,
K United Kingdom
Tel: +44(0) 1452 729428 / 1452 729696
Fax: +44 (0)1452-690125
E-mail: Sales.Europe@leoch.com